

S:\work\from-server2\PROJETS\2016 Projects\16-0535-008 Cockburn Calrossie\Working\Cockburn Calrossie-PLAN WETLAND-UPLAND CURRENT.dwg

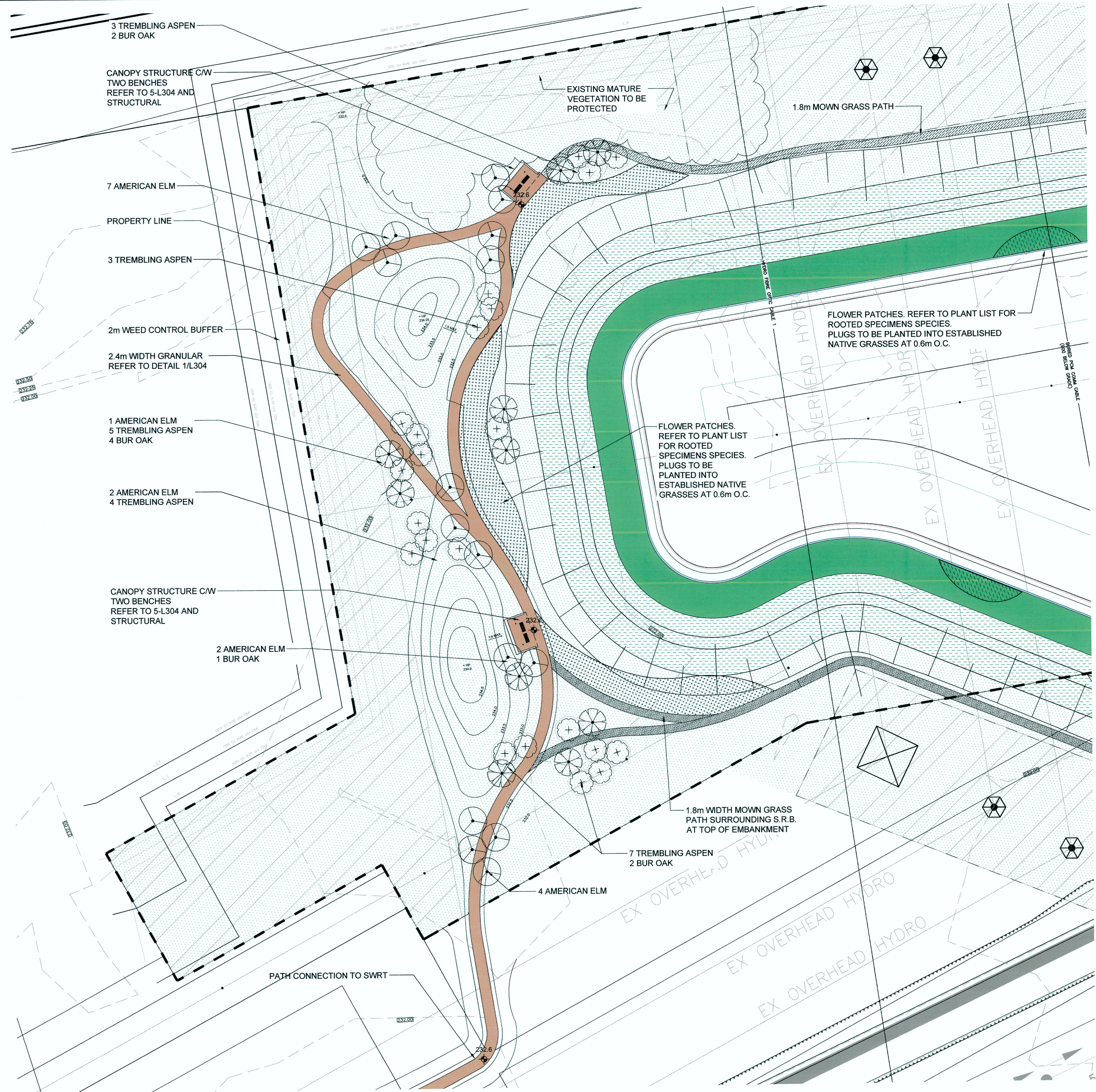

1 PATH GRADING AND LAYOUT
L303 1:500

| WEST LAKE EXPANSION / PENINSULA PLANTING SCHEDULE | | | | | |
|---|---|--|-----|--|--------------------|
| SYMBOL | COMMON NAME | BOTANICAL NAME | QNT | SIZE AND REMARKS (shown are minimum specifications) | MIN SPACING (O.C.) |
| TREES | | | | | |
| | AMERICAN ELM | <i>Ulmus americana</i> | 40 | 60mm CALIPER, 3.5 TO 4.0m ht., 11 MAJOR BRANCHES 2.0m ABOVE GRADE IN WELL BALANCED HEAD STRAIGHT TRUNK, WIRE BASKET MACHINE DUG | 5.0m |
| | BUR OAK | <i>Quercus macrocarpa</i> | 10 | 50mm CALIPER, 3.5 TO 4.0m ht., 10 MAJOR BRANCHES 2.0m ABOVE GRADE IN WELL BALANCED HEAD, STRAIGHT TRUNK, WIRE BASKET MACHINE DUG | 4.0m |
| | TREMBLING ASPEN | <i>Populus tremuloides</i> | 22 | 60mm CALIPER, 3.5 TO 4.0m ht., 11 MAJOR BRANCHES 2.0m ABOVE GRADE IN WELL BALANCED HEAD STRAIGHT TRUNK, WIRE BASKET MACHINE DUG | 4.0m |
| FLOWER PATCHES ROOTED SPECIMENS | | | | | |
| | ROOTED SPECIMENS IN MEDIUM HEIGHT GRASSES | | | | |
| | DWARF MILKWEED | <i>A. ovalifolia</i> | 200 | 1 YR. PLANTS FROM SEED, WELL DEVELOPED, VIGOROUS ROOT SYSTEM | 600mm O.C. |
| | BLACK EYED SUSAN | <i>Rudbeckia hirta</i> | 200 | 1 YR. PLANTS FROM SEED, WELL DEVELOPED, VIGOROUS ROOT SYSTEM | 600mm O.C. |
| | GIANT HYSSOP | <i>Agastache foeniculum</i> | 200 | 1 YR. PLANTS FROM SEED, WELL DEVELOPED, VIGOROUS ROOT SYSTEM | 600mm O.C. |
| | MANY FLOWERED ASTER | <i>Symphotrichum ericoides</i> | 200 | 1 YR. PLANTS FROM SEED, WELL DEVELOPED, VIGOROUS ROOT SYSTEM | 600mm O.C. |
| | MEADOW BLAZING STAR | <i>Liatris ligulistylis</i> | 200 | 1 YR. PLANTS FROM SEED, WELL DEVELOPED, VIGOROUS ROOT SYSTEM | 600mm O.C. |
| | NARROW-LEAF SUNFLOWER | <i>Helianthus maximiliani</i> | 200 | 1 YR. PLANTS FROM SEED, WELL DEVELOPED, VIGOROUS ROOT SYSTEM | 600mm O.C. |
| | NEW ENGLAND ASTER | <i>Symphotrichum novae-angliae</i> | 200 | 1 YR. PLANTS FROM SEED, WELL DEVELOPED, VIGOROUS ROOT SYSTEM | 600mm O.C. |
| | PRAIRIE CONEFLOWER | <i>Ratibida columifera</i> | 200 | 1 YR. PLANTS FROM SEED, WELL DEVELOPED, VIGOROUS ROOT SYSTEM | 600mm O.C. |
| | PURPLE PRAIRIE CLOVER | <i>Dalea purpurea</i> | 200 | 1 YR. PLANTS FROM SEED, WELL DEVELOPED, VIGOROUS ROOT SYSTEM | 600mm O.C. |
| | SHOWY GOLDENROD | <i>Solidago nemoralis</i> | 200 | 1 YR. PLANTS FROM SEED, WELL DEVELOPED, VIGOROUS ROOT SYSTEM | 600mm O.C. |
| | SMOOTH ASTER | <i>Symphotrichum laeve</i> | 200 | 1 YR. PLANTS FROM SEED, WELL DEVELOPED, VIGOROUS ROOT SYSTEM | 600mm O.C. |
| | STIFF GOLDENROD | <i>Loligoneuron rigidum var. rigidum</i> | 200 | 1 YR. PLANTS FROM SEED, WELL DEVELOPED, VIGOROUS ROOT SYSTEM | 600mm O.C. |
| | THREE FLOWERED AVENS | <i>Geum triflorum</i> | 200 | 1 YR. PLANTS FROM SEED, WELL DEVELOPED, VIGOROUS ROOT SYSTEM | 600mm O.C. |
| | WESTERN SILVERY ASTER | <i>Symphotrichum sericeum</i> | 200 | 1 YR. PLANTS FROM SEED, WELL DEVELOPED, VIGOROUS ROOT SYSTEM | 600mm O.C. |
| | WILD BERGAMOT | <i>Monarda fistulosa</i> | 200 | 1 YR. PLANTS FROM SEED, WELL DEVELOPED, VIGOROUS ROOT SYSTEM | 600mm O.C. |
| | YARROW | <i>Achillea millefolium</i> | 200 | 1 YR. PLANTS FROM SEED, WELL DEVELOPED, VIGOROUS ROOT SYSTEM | 600mm O.C. |
| | ROOTED SPECIMENS IN TALL GRASSES | | | | |
| | SWAMP MILKWEED | <i>A. incarnata</i> | 420 | 1 YR. PLANTS FROM SEED, WELL DEVELOPED, VIGOROUS ROOT SYSTEM | 600mm O.C. |
| | CULVER'S ROOT | <i>Veronicastrum virginicum</i> | 420 | 1 YR. PLANTS FROM SEED, WELL DEVELOPED, VIGOROUS ROOT SYSTEM | 600mm O.C. |

LAYOUT NOTES

- EXACT LOCATION OF PATHWAY, BERM AND SWALE TO BE LOCATED ON SITE. ALL LAYOUT TO BE APPROVED BY LANDSCAPE ARCHITECT PRIOR TO ANY CONSTRUCTION OR REMOVAL
- CONFIRMATION OF EXISTENCE AND EXACT LOCATION OF ALL SERVICES MUST BE OBTAINED FROM THE INDIVIDUAL UTILITIES BEFORE PROCEEDING WITH CONSTRUCTION
- REFER ALSO TO WRITTEN SPECIFICATIONS

GRADING NOTES

- EXISTING GRADE TO BE MAINTAINED AT ALL PROPERTY LINES, UTILITIES, CITY SIDEWALKS AND TREES, UNLESS NOTED OTHERWISE
- ALL GRADING TO BE APPROVED BY LANDSCAPE ARCHITECT PRIOR TO ANY CONSTRUCTION.
- ALL PROPOSED ELEVATIONS TO BE FINISHED ELEVATIONS
- ENSURE POSITIVE DRAINAGE IN ALL AREAS
- CROWN ON ALL PATHS CROSSLOPE TO ENSURE POSITIVE DRAINAGE
- SLOPE TOLERANCE:
- PAVED AREA SLOPES: MAXIMUM 5%, MINIMUM 1%; MAXIMUM CROSS SLOPE 1.5%
- SEEDED AREA SLOPES: MAXIMUM 25%, MINIMUM 1%
- ANY DEVIATION FROM THE ABOVE SLOPES TO BE APPROVED BY LANDSCAPE ARCHITECT PRIOR TO CONSTRUCTION

LEGEND

| | |
|--|-------------------|
| | EXISTING CONTOURS |
| | PROPOSED CONTOURS |

| | | | | | | | |
|--|---------------------------|--|--|--------------------------|--|---------------------|--|
| | WATER MAIN | | | HYDRO | | WATER MAIN | |
| | HYDRANT VALVE | | | M.T.S. CONCRETE | | HYDRANT, VALVE | |
| | LAND DRAINAGE SEWER | | | ASPHALT | | LAND DRAINAGE SEWER | |
| | WASTE WATER SEWER MANHOLE | | | SIDEWALK | | WASTE WATER SEWER | |
| | CATCH BASIN | | | PROPERTY LINE SURVEY BAR | | CENTRELINE | |
| | CURB INLET | | | GAS | | NORTH/WEST GUTTER | |
| | BEND | | | CURB STOP | | SOUTH/EAST GUTTER | |
| | REDUCER | | | TEE | | N/W, S/E R'S | |
| | LEGEND-PLAN | | | LEGEND-PLAN | | LEGEND-PROFILE | |
| | PROPOSED | | | PROPOSED | | PROPOSED | |

LOCATION APPROVED UNDERGROUND STRUCTURES

SUPV. U/G STRUCTURES DATE COMMITTEE

NOTE:
LOCATION OF UNDERGROUND STRUCTURES AS SHOWN ARE BASED ON THE BEST INFORMATION AVAILABLE BUT NO GUARANTEE IS GIVEN THAT ALL EXISTING UTILITIES ARE SHOWN OR THAT THE GIVEN LOCATIONS ARE EXACT. CONFIRMATION OF EXISTENCE AND EXACT LOCATION OF ALL SERVICES MUST BE OBTAINED FROM THE INDIVIDUAL UTILITIES BEFORE PROCEEDING WITH CONSTRUCTION.

| | | | |
|------------|-----------|------|----|
| B.M. ELEV. | | | |
| NO. | REVISIONS | DATE | BY |
| | | | |
| | | | |

SCATLIFF + MILLER + MURRAY
visionary urban design + landscapes

| | |
|-----------------------------|--|
| DESIGNED BY: MB / CP | CHECKED BY: DM |
| DRAWN BY: MB / WF | APPROVED BY: DM |
| HOR. SCALE: AS NOTED | RELEASED FOR CONSTRUCTION: DATE |
| VERTICAL: 16/06/10 | |

CONSULTANT DRAWING NO. L303

THE CITY OF WINNIPEG
WATER AND WASTE DEPARTMENT

PROJECT TITLE: **COCKBURN/CALROSSIE COMBINED SEWER RELIEF WORKS**

STORMWATER RETENTION BASIN PATH DETAIL

| | |
|---------------------|---------|
| SHEET OF | 1 OF 1 |
| COMPUTER FILE NAME | |
| CITY DRAWING NUMBER | LD-8234 |